

Waukesha City Hall Waukesha, WI

BWB R

1241 John Q Hammons Dr., Ste. 503 Madison, WI 53717 608.829.3701 bwbr.com

Consultants

This document may be an electronic file or may be printed from an electronic file provided to the user. It is the sole responsibility of the user to ensure that the content and quality is consistent with the content and quality of the original documents on file at BWBR.

Issued For

Item	Date
DD ISSUE	04/05/2019
50% CD ISSUE	05/17/2019
90% CD ISSUE	06/06/2019
CD ISSUE	07/10/2019

This Sheet may be a Reduced Copy. The bar above is 1" long on a Full Size Sheet. Drawing Scales apply to Full Size Sheets.

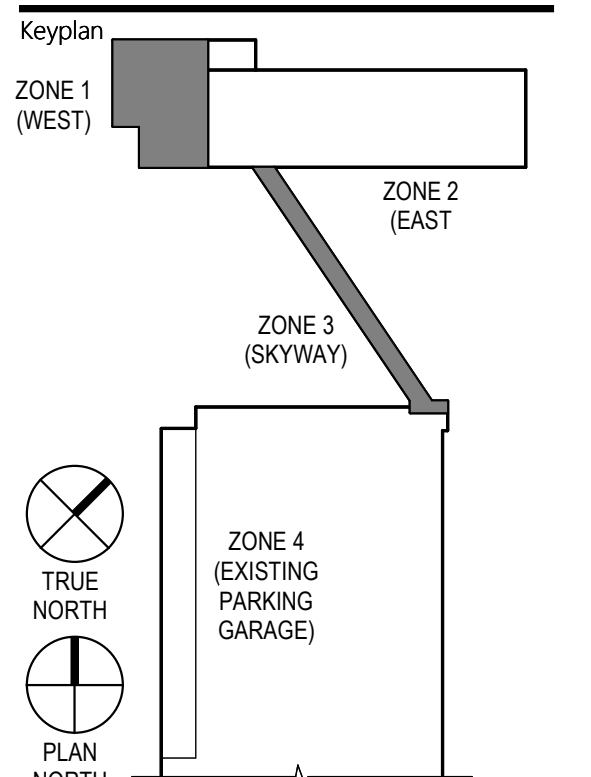

Comm. No. 3.2018006.01 Drawn PH/ARS/DIS

Sheet Title FIRST LEVEL ZONE 1 AND 3 - FLOOR PLAN

Sheet No.

401.1FL

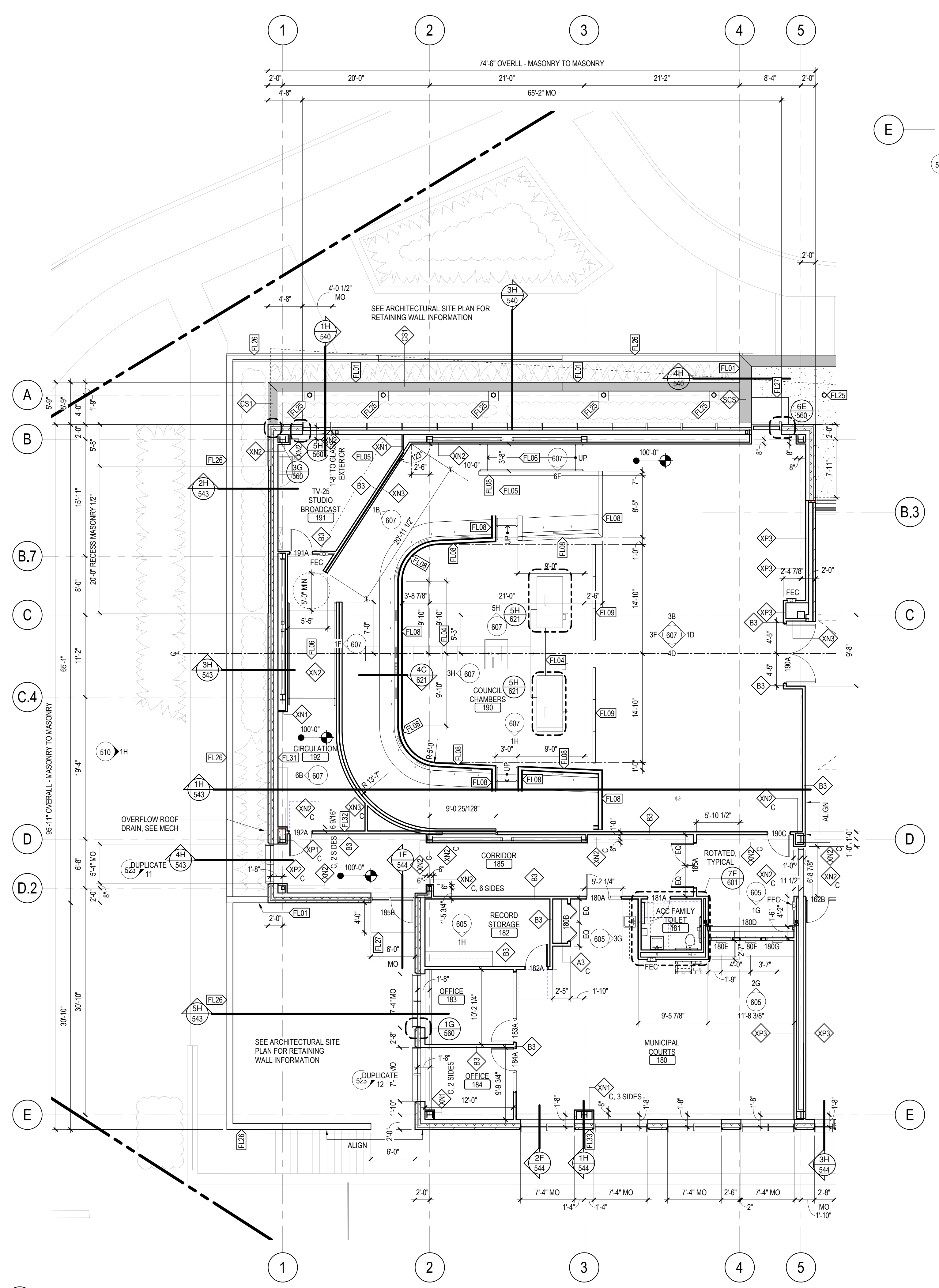

1G FLOOR PLAN - FIRST LEVEL - ZONE 1 401.1FL 1/8" = 1'-0"

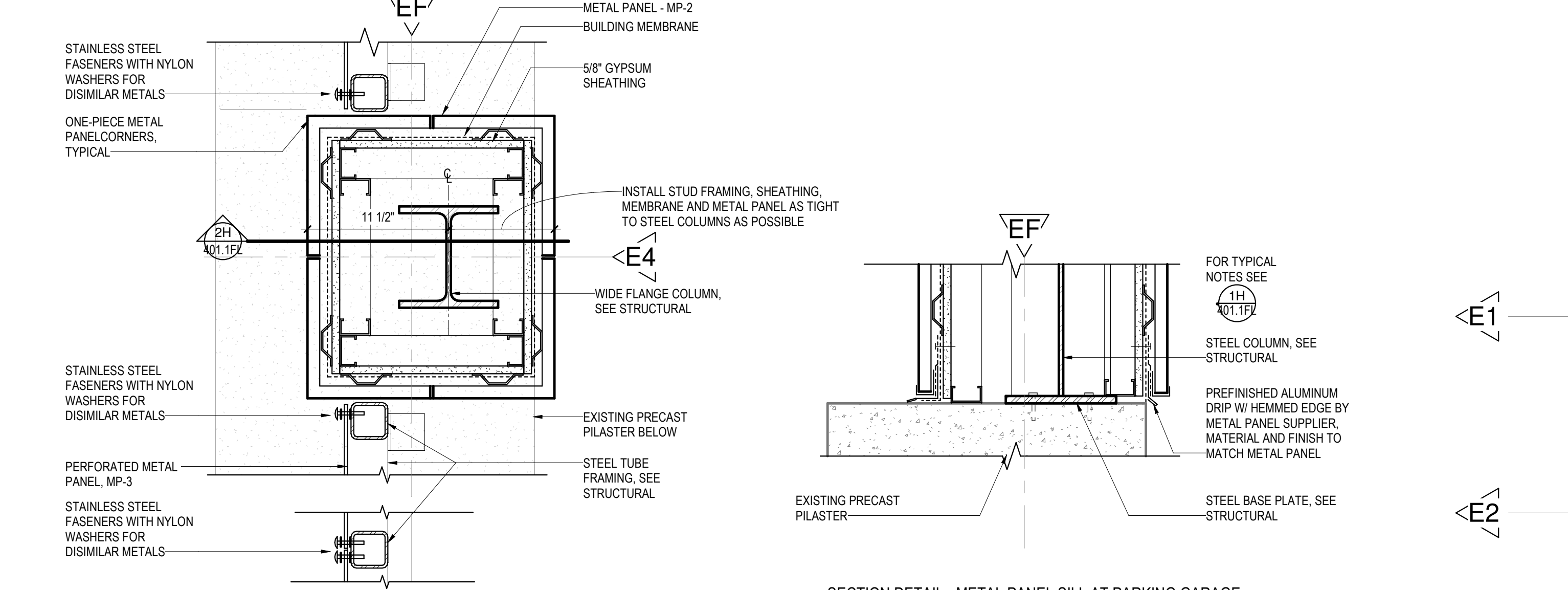

1H PLAN DETAIL - STEEL FRAMED CANOPY COLUMN ENCLOSURE 401.1FL 1 1/2" = 1'-0" 2H SECTION DETAIL - METAL PANEL SILL AT PARKING GARAGE 401.1FL 1 1/2" = 1'-0"

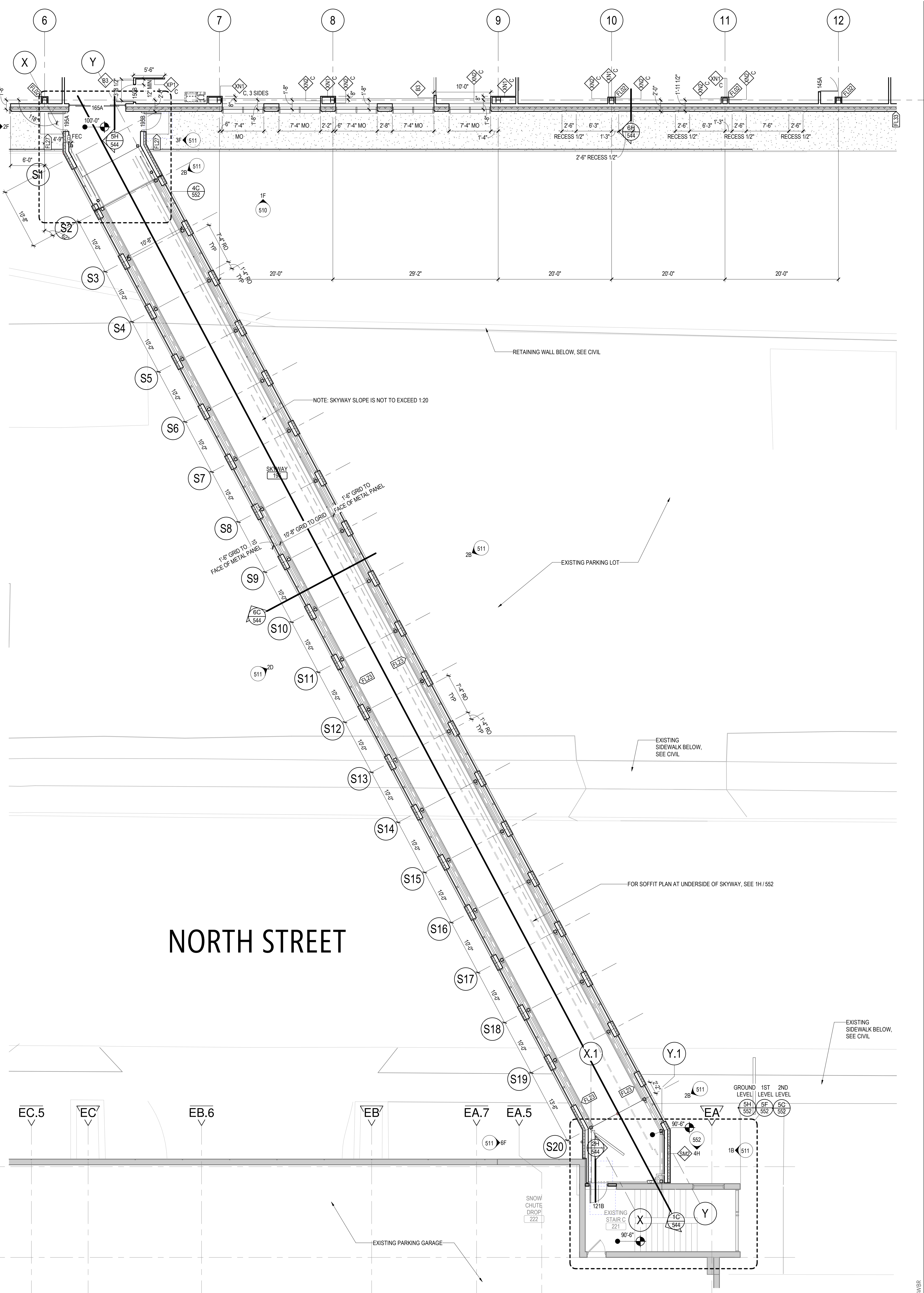

3H FLOOR PLAN - FIRST LEVEL - ZONE 3 401.1FL 1/8" = 1'-0"

7/10/2019 3:53:13 PM

COPYRIGHT BWBR